

## **FLEXIBLE BENCH FOR ULTRASONIC SHOT PEENING - STRESSONIC®**

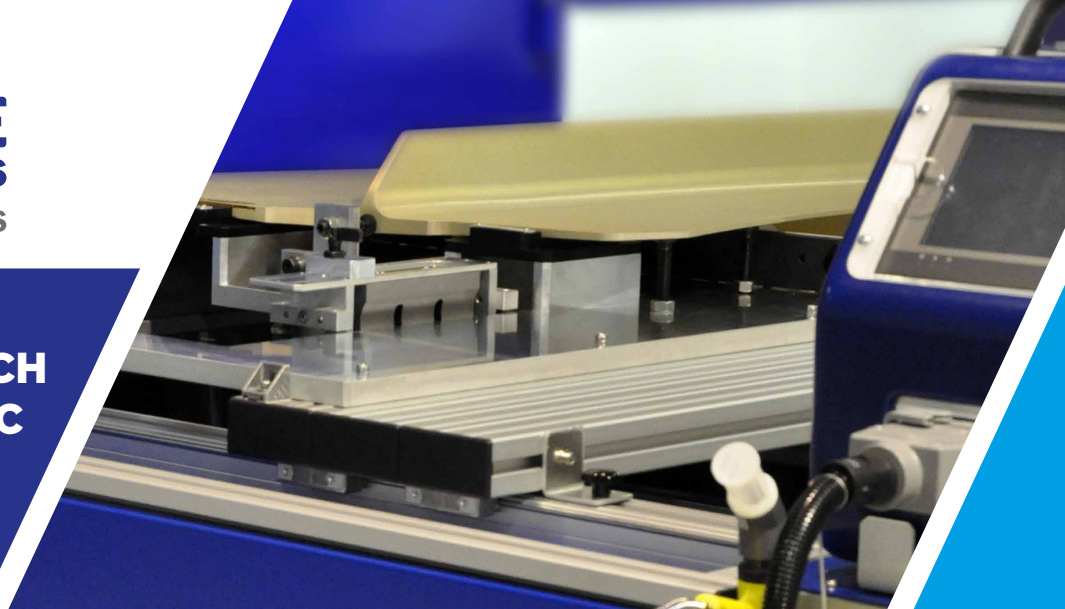

### **A FLEXIBLE BENCH PROVIDING VARIOUS TREATMENT CONFIGURATIONS**

The flexible bench can be used in workshop or laboratory in order to define shot peening parameters, or for manual treatment of parts. The toolings are placed and fixed on the adjustable tray. The acoustic unit is precisely adjusted in a horizontal and vertical way as well as its gradient (until 45°, according to configurations and selected options).

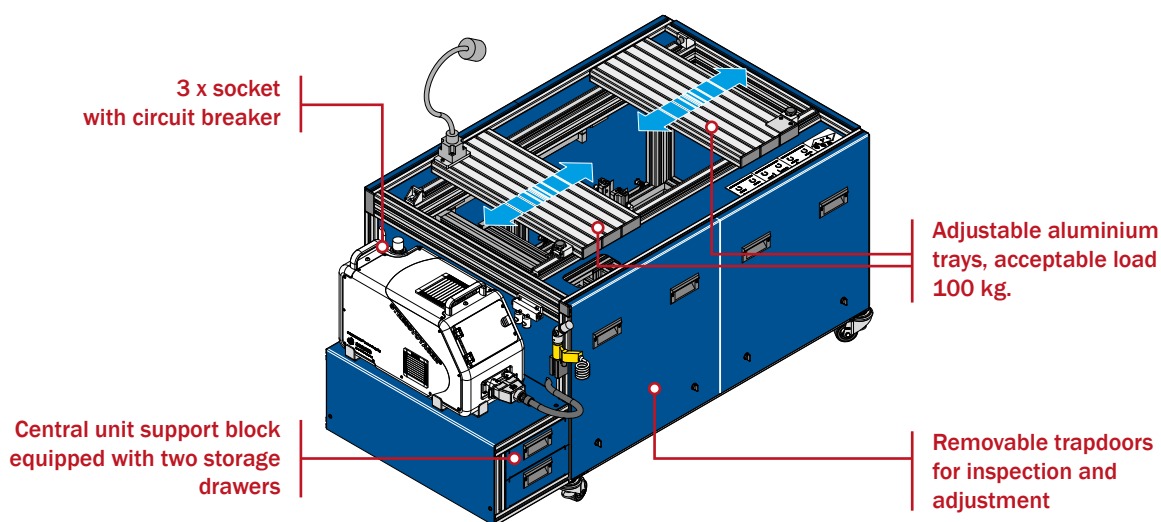

*Flexible bench equipped with optionnal accessories*

- Trays and support of the acoustic unit adjustable.
- Suitable for the connection to the central unit.
- Fits to the USP STRESSVOYAGER® and SUPARAM STRESSONIC® module (customisable supervision).

Our solutions are qualified by the biggest companies :  
AIRBUS, DASSAULT, SAFRAN, GULFSTREAM

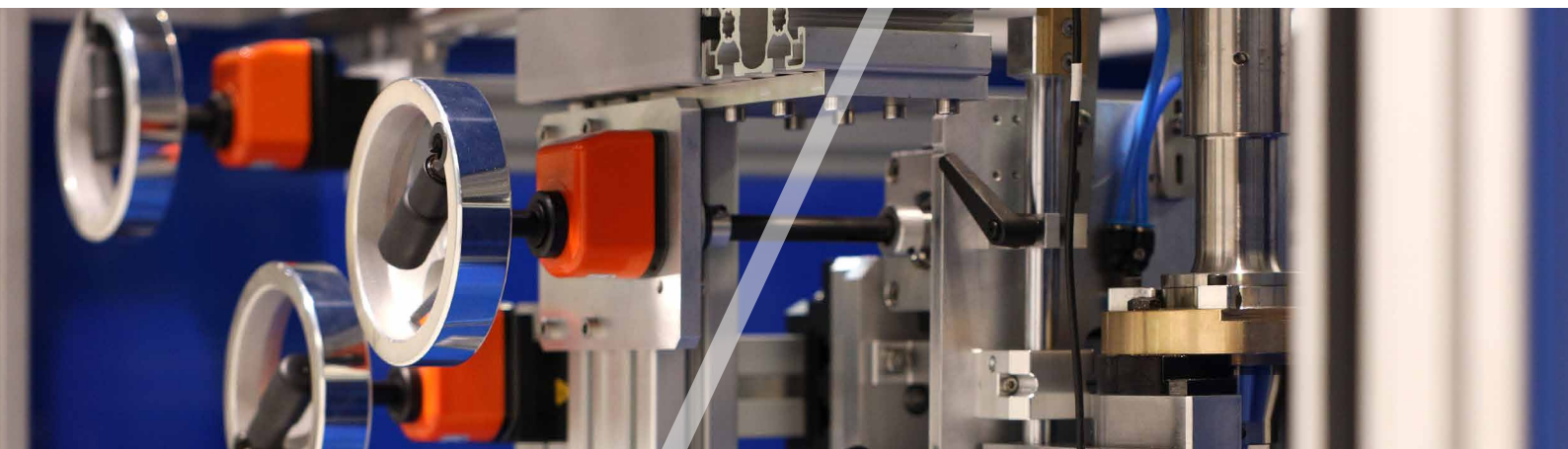

## OPTIONS AND ACCESSORIES

### Treatment

- Acoustic support 1 or 3 axis (1)
- Adjustable acoustic support 0 - 45° (2)
- Positioning gauge (3)

### Ergonomic design

- Tray lighting (4)
- Lockable castors (5)
- Adjustable feet high (6)
- Support of media intake system (7)

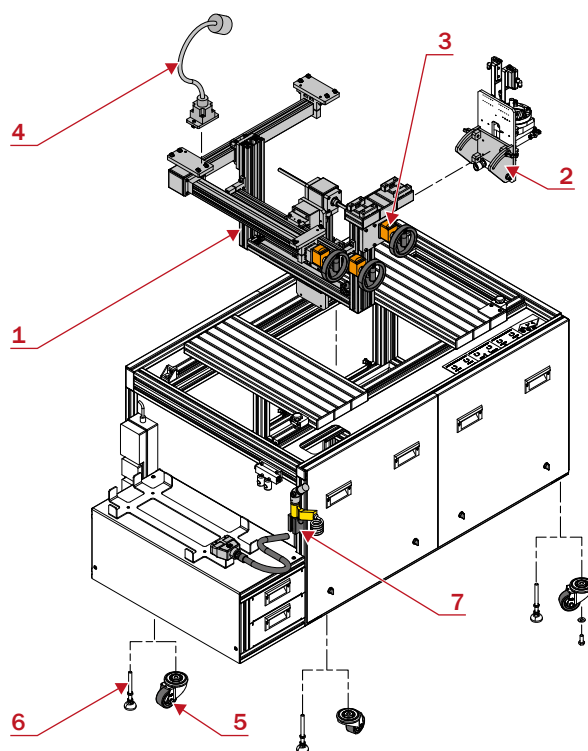

*Flexible bench options and accessories*

## CHARACTERISTICS

### Use

- Max. acceptable load on tray : 100 kg.

### Physical

|                   |                                       |                       |
|-------------------|---------------------------------------|-----------------------|
| <b>Dimensions</b> | L x l x h (hors-tout)                 | 1720 x 993 x 895 mm   |
|                   | Trays                                 | 270 x 700 mm per tray |
|                   | Max. vacuum between trays (separated) | 658 mm                |
| <b>Weight</b>     | Except tooling                        | 250 kg                |

